

INSTRUCTION SHEET

HOLLEY CARBURETOR—MODEL 5210-C

AMC 4 CYL ENGINE

50-541-2

GENERAL EXPLODED VIEW

THE GENERAL DESIGN AND PARTS SHOWN WILL VARY TO INDIVIDUAL UNITS COVERED ON THIS INSTRUCTION SHEET

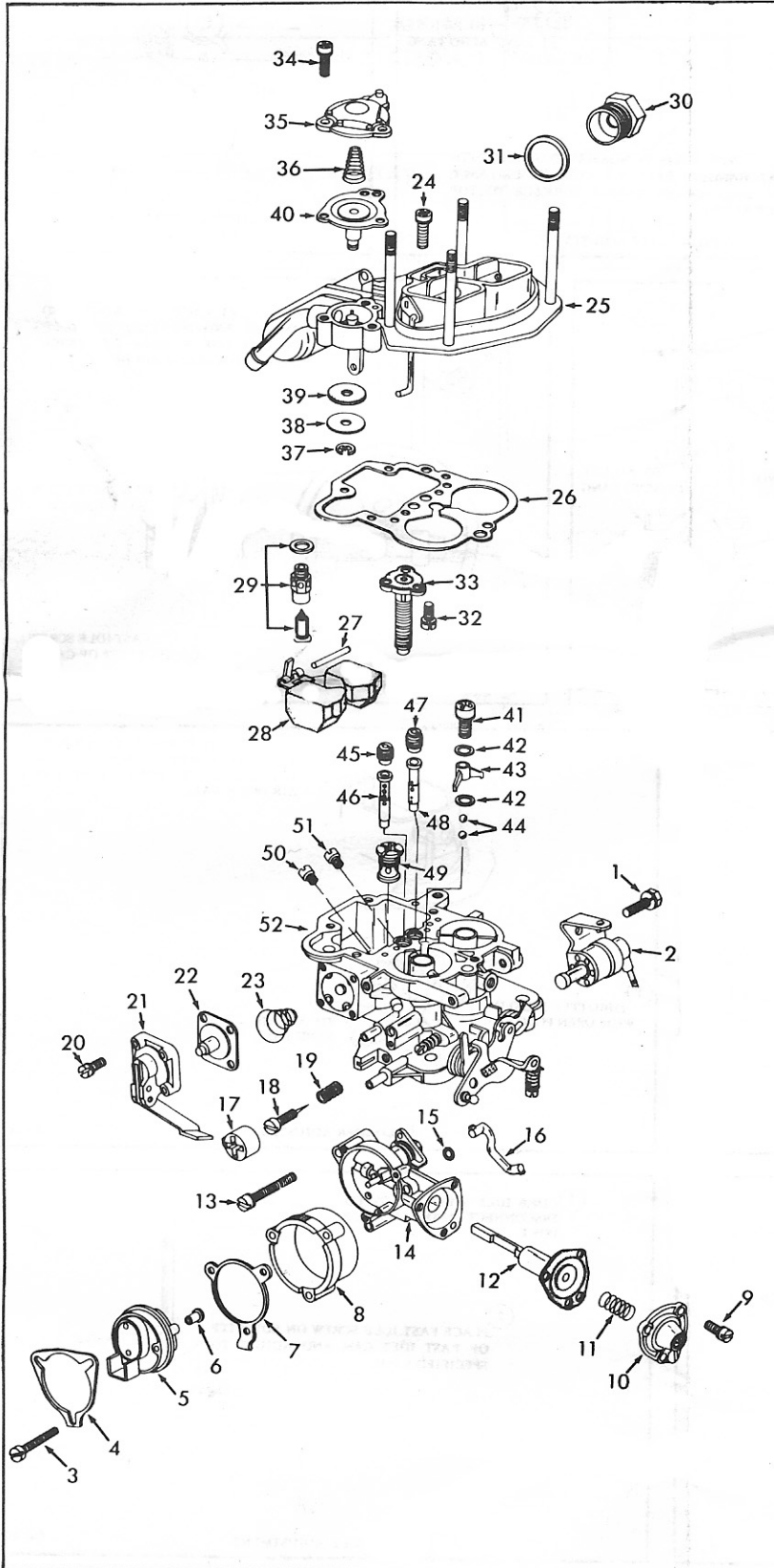

DISASSEMBLY

USE EXPLODED VIEW AS A GUIDE. THE NUMERICAL SEQUENCE MAY GENERALLY BE FOLLOWED TO DISASSEMBLE UNIT FAR ENOUGH TO PERMIT CLEANING AND INSPECTION. CAUTION: NOTE SIZES OF JETS AND MAIN WELL TUBES AND THEIR LOCATION FOR PROPER ASSEMBLY (RECORD SIZES BELOW.)

NOMENCLATURE

REF. NO.	REF. NO.
1. SCREW & LKWSHR. (2) - SOLENOID	27. PIN - FLOAT
2. SOLENOID - IDLE STOP	28. FLOAT ASSY.
3. SCREW (3) - CHOKE RETAINER	29. NEEDLE, SEAT AND GASKET ASSY.
4. RETAINER - CHOKE COVER	30. NUT - FUEL INLET
5. CHOKE COVER AND COIL ASSY.	31. GASKET - INLET NUT
6. BUSHING - COIL SPRING LOOP	32. SCREW & LKWSHR. (3) - DIAPHRAGM ASSY.
7. RING - CHOKE GROUND	33. DIAPHRAGM ASSY. - ECONOMIZER
8. HOUSING - CHOKE COIL ASSY.	34. SCREW & LKWSHR (3) - COVER
9. SCREW & LKWSHR. (3) - COVER	35. COVER - DIAPHRAGM
10. COVER ASSY. - DIAPHRAGM	36. SPRING - DIAPHRAGM RETURN
11. SPRING - DIAPHRAGM	37. E CLIP - WASHER
12. DIAPHRAGM ASSY. - CHOKE	38. WASHER - VENT VALVE
13. SCREW & LKWSHR (3) - CHOKE HOUSING	39. VALVE - VENT
14. CHOKE & DIAPHRAGM HOUSING ASSY.	40. DIAPHRAGM ASSY. - VENT VALVE
15. O-RING - CHOKE HOUSING ASSY.	41. SCREW - PUMP DISC. NOZZLE
16. ROD - FAST IDLE	42. GASKET - PUMP NOZZLE
17. CAP - IDLE LIMITER	43. NOZZLE - PUMP DISCHARGE
18. NEEDLE - IDLE ADJUSTING	44. BALL (2) - PUMP DISCHARGE
19. SPRING - IDLE ADJ. NEEDLE	45. JET - PRI. HIGH SPEED BLEED
20. SCREW & LKWSHR (4) - PUMP COVER	46. TUBE - PRI. MAIN WELL
21. COVER ASSY. - PUMP	47. JET - SEC. HIGH SPEED BLEED
22. DIAPHRAGM ASSY. - PUMP	48. TUBE - SEC. MAIN WELL
23. SPRING - PUMP RETURN	49. POWER VALVE ASSY.
24. SCREW & LKWSHR (5) - BOWL COVER	50. JET - PRI. MAIN
25. BOWL COVER ASSY.	51. JET - SEC. MAIN
26. GASKET - BOWL COVER	52. MAIN BODY ASSY.

CLEANING

CLEANING MUST BE DONE WITH CARBURETOR DISASSEMBLED. SOAK PARTS LONG ENOUGH TO SOFTEN AND REMOVE ALL FOREIGN MATERIALS. USE A CARBURETOR CLEANING SOLVENT. MAKE CERTAIN THE THROTTLE BORES ARE FREE OF ALL CARBON AND VARNISH DEPOSITS. RINSE OFF IN SUITABLE SOLVENT. BLOW OUT ALL PASSAGES IN CASTINGS WITH COMPRESSED AIR AND CHECK CAREFULLY TO INSURE THOROUGH CLEANING OF OBSCURE AREAS. CAUTION: DO NOT SOAK PARTS CONTAINING RUBBER MATERIALS, SOLENOIDS, OR PLASTIC FLOAT.

REASSEMBLY

REASSEMBLE IN REVERSE ORDER OF DISASSEMBLY. NOTE SPECIAL INSTRUCTIONS AND FOLLOW NUMERICAL OUTLINE IN MAKING ADJUSTMENTS.

SPECIAL INSTRUCTIONS

CHECK BALLS (44) - ALL MODELS USE 2 BALLS. ONE IS USED FOR A WEIGHT.

SPRING (36) - INSTALL WITH SMALL END TOWARDS COVER.

ECONOMIZER DIAPHRAGM ASSEMBLY (33) - CAREFULLY ALIGN HOLES IN DIAPHRAGM TO PREVENT DAMAGE WHILE INSTALLING SCREWS.

PUMP RETURN SPRING (23) - INSTALL WITH SMALL END AGAINST CARBURETOR BOWL.

IDLE ADJUSTING NEEDLE (18) - TURN IN UNTIL SEATED, THEN BACK OUT 2 1/2 TURNS (DO NOT INSTALL LIMITER CAP AT THIS TIME.)

CHOKE COVER (5) - INSTALL BUSHING (6) - IN LOOP END OF COIL SPRING BEFORE INSTALLING ON PIN OF LEVER.

ADJUSTMENTS

CAUTION: DO NOT EXERT PRESSURE ON RESILIENT NEEDLE VALVE.

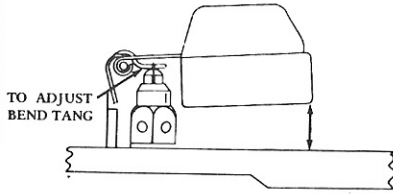

BOWL COVER INVERTED (BOWL COVER GASKET REMOVED). FLOAT RESTING ON NEEDLE VALVE OF ITS OWN WEIGHT. (DO NOT COMPRESS SPRING). MEASURE DISTANCE FROM FLOAT AT TOE END TO CASTING SURFACE.

(CHECK BOTH FLOATS)

DRY FLOAT LEVEL ADJUSTMENT

Fig. 1

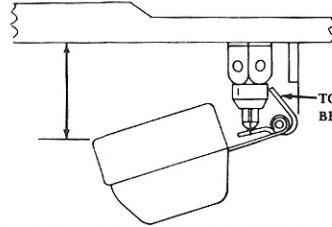

BOWL COVER HELD IN NORMAL POSITION WITH FLOAT HANGING FREELY. MEASURE DISTANCE FROM BOWL COVER GASKET SURFACE TO TOP TOE OF FLOAT.

FLOAT DROP ADJUSTMENT

Fig. 2

BACK OUT STOP SCREW UNTIL SECONDARY THROTTLE VALVE SEATS IN BORE. TURN SCREW IN UNTIL IT TOUCHES SECONDARY THROTTLE LEVER, THEN TURN IN AN ADDITIONAL 1/4 TURN.

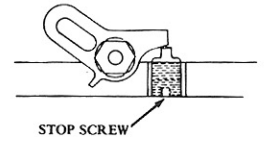

STOP SCREW

SECONDARY THROTTLE STOP ADJUSTMENT

Fig. 3

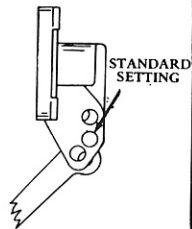

STANDARD SETTING

PUMP-POSITION HOLE

Fig. 4

2 HOLD CHOKE VALVE TOWARD CLOSED POSITION AND MEASURE DISTANCE BETWEEN LOWER EDGE OF CHOKE PLATE AND AIR HORN WALL.

1 HOLD FAST IDLE SCREW ON SECOND STEP AND AGAINST THE SHOULDER OF THE FIRST STEP OF FAST IDLE CAM.

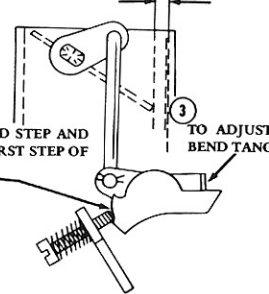

TO ADJUST BEND TANG

FAST IDLE CAM INDEX ADJUSTMENT

Fig. 5

3 HOLD CHOKE VALVE TOWARD CLOSED POSITION AND MEASURE DISTANCE BETWEEN LOWER EDGE OF CHOKE PLATE AND WALL OF AIR HORN.

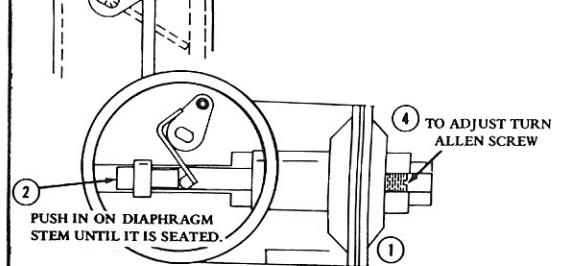

TO ADJUST TURN ALLEN SCREW

2 PUSH IN ON DIAPHRAGM STEM UNTIL IT IS SEATED.

1 PLACE FAST IDLE SCREW ON HIGH STEP OF CAM.

CHOKE PULLDOWN ADJUSTMENT

Fig. 6

ROTATE CHOKE COVER AGAINST SPRING TENSION. SET MARK ON COVER TO SPECIFIED POINT ON CHOKE HOUSING.

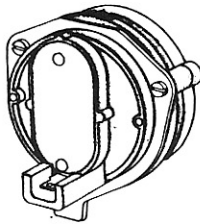

AUTOMATIC CHOKE ADJUSTMENT

Fig. 7

2 CHOKE HELD TOWARD CLOSED POSITION. MEASURE DISTANCE BETWEEN LOWER EDGE OF CHOKE VALVE AND AIR HORN WALL.

1 THROTTLE HELD IN WIDE OPEN POSITION.

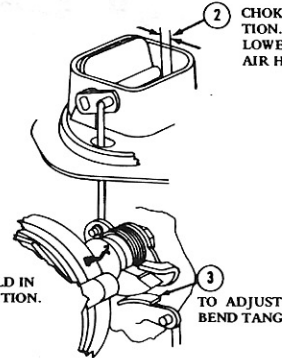

TO ADJUST BEND TANG

UNLOADER ADJUSTMENT

Fig. 8

USE FACTORY CAR MANUAL PROCEDURE FOR SETTING SLOW IDLE AND SPECIFICATIONS LISTED ON ENGINE DECAL.

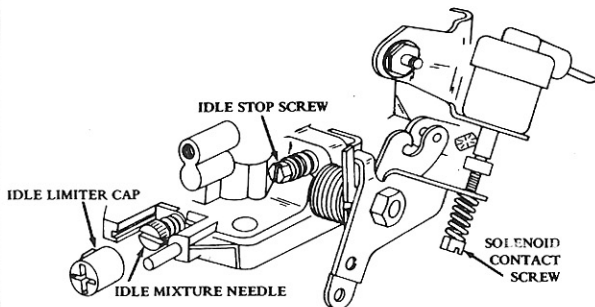

IDLE ADJUSTMENT

Fig. 9

1 CURB IDLE SPEED ADJUSTED. DISCONNECT AND PLUG EGR PORT.

2 PLACE FAST IDLE SCREW ON LOW STEP OF FAST IDLE CAM AND ADJUST TO SPECIFIED R.P.M.

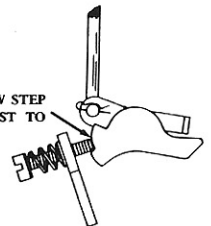

FAST IDLE ADJUSTMENT

Fig. 10

ADJUSTMENT DATA TABLE

YEAR	APPLICATION AMC PRODUCTS	DRY FLOAT LEVEL	FLOAT DROP	FAST IDLE CAM INDEX ADJ.	CHOKE PULLDOWN ADJ.	AUTO. CHOKE SETTING	UN- LOADER ADJ.	FAST IDLE R.P.M. *
1977	4 CYL. ENG. 49 STATES ALL/T	7/16"	1"	9/64"	1/4"	1-RICH	5/16"	1600
	CALIF. A/T	7/16"	1"	7/64"	13/64"	1-RICH	5/16"	1600
	ALT. M/T	7/16"	1"	9/64"	7/32"	INDEX	5/16"	1600
1978	4 CYL. ENG. 49 STATES A/T	7/16"	1"	13/64"	13/64"	1-RICH	5/16"	1800
	M/T	7/16"	1"	3/16"	3/16"	1-RICH	5/16"	1800
	CALIF.	7/16"	1"	3/16"	3/16"	1-RICH	5/16"	1800
	ALT. M/T	7/16"	1"	11/64"	3/16"	INDEX	5/16"	1800
1979	4 CYL. ENG. 49 STATES A/T	7/16"	1"	13/64"	3/16"	1-RICH	5/16"	1800
	M/T	7/16"	1"	3/16"	17/64"	1-RICH	5/16"	1800
	CALIF. A/T	7/16"	1"	3/16"	3/16"	1-RICH	5/16"	1800
	(R-8675A) Hilly Terrain M/T	7/16"	1"	11/64"	11/64"	INDEX	5/16"	1800

*check engine decal.